

# Vertiv™ Liebert® Power-UPS Lithium

## PUL-400LVT / VPUL-400LVTR 120V 400VA – 240W

### Quick Installation Guide



Learn more about your Vertiv UPS



Register your purchase

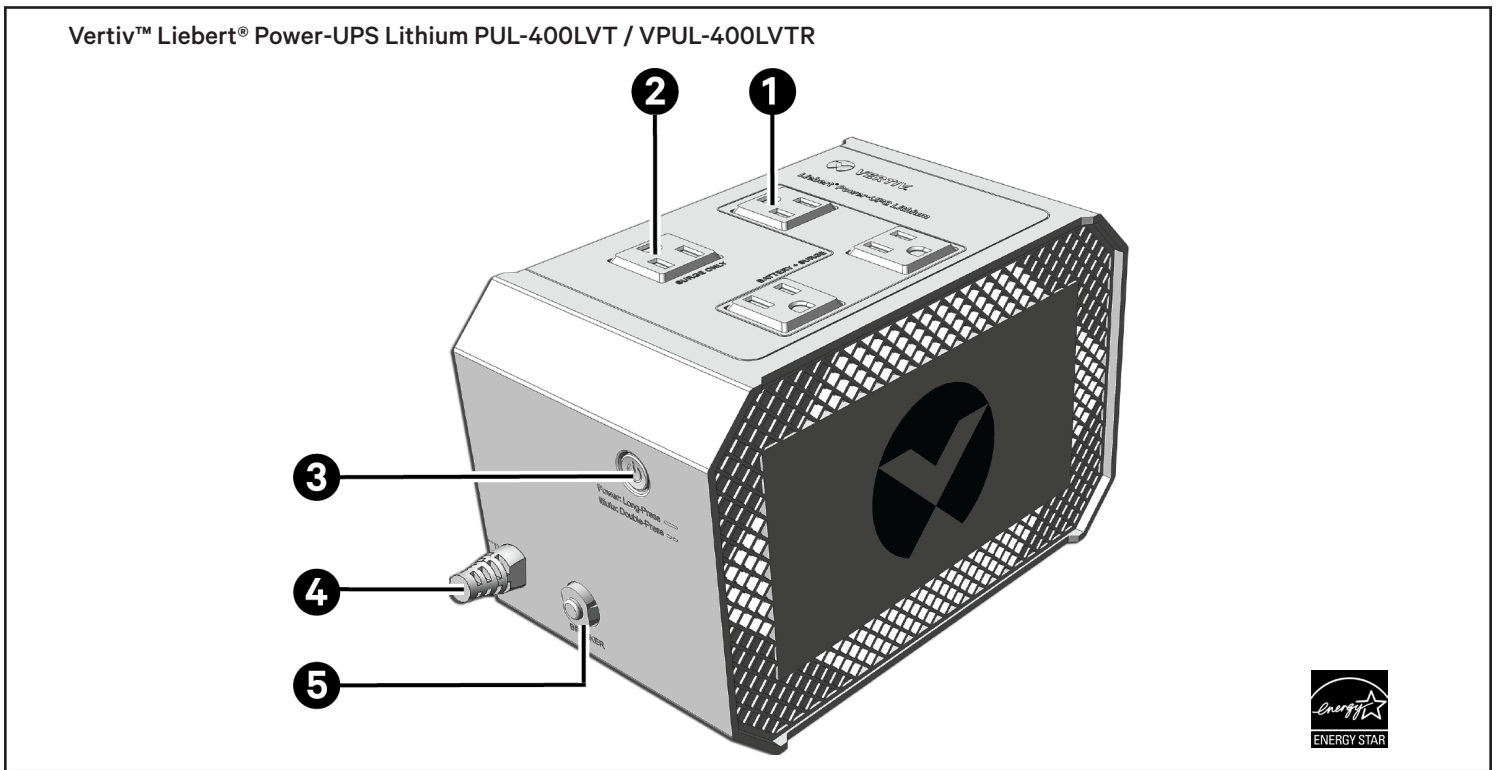

Item No.	Description
1	Battery backup and surge protection outlets
2	Surge only outlet
3	Power and Mute button
4	Input cord
5	Circuit breaker

Alarm Details		
Indicators	LED Indicator	Alarm Frequency
Normal Operation	Solid green	No audible noise
Battery Mode	Blinking green	1 beep every 10 seconds
UPS Warning	Solid red	1 beep every second
Low-Battery Warning	Blinking green	1 beep every 2 seconds
UPS Fault	Soild red	Constant, solid beep

**Warranty Information:** Vertiv backs all Vertiv™ Liebert® Power-UPS Lithium UPS systems with a 5 year advanced replacement warranty.

Quick Installation Guide

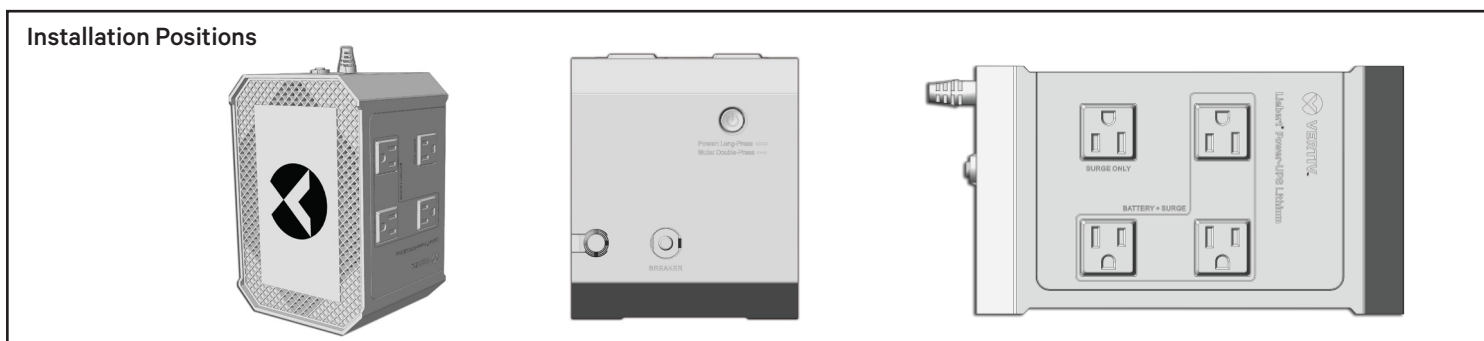
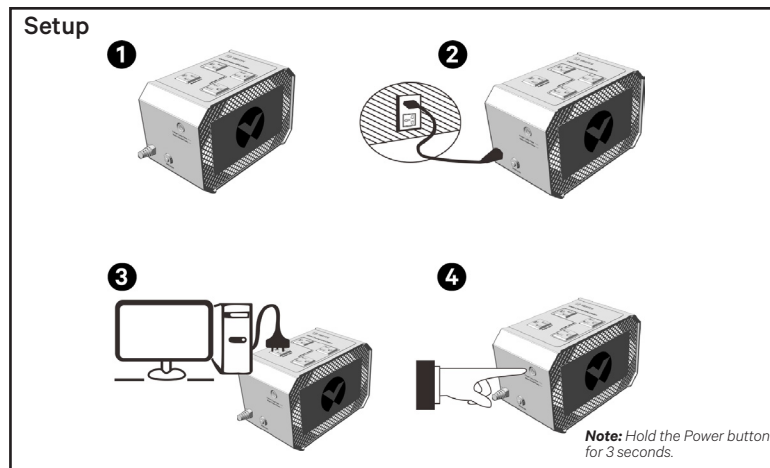
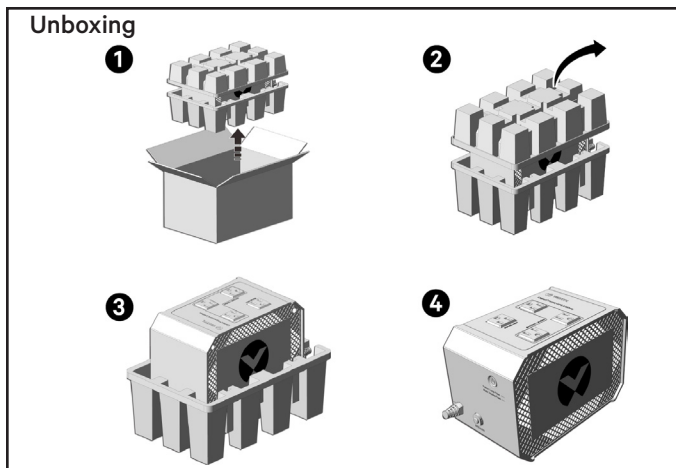

Troubleshooting Details			
Item No.	Symptom	Possible Cause	Corrective Action
1	UPS does not turn on.	The <i>Power/Mute</i> button is not pressed.	Press and hold the <i>Power/Mute</i> button for 3 seconds and then release it to power on the UPS.
2	UPS operates only in battery mode, even when there is normal AC present. Fault icon is illuminated.	UPS input cord is not plugged in or the external AC circuit breaker is tripped.  The wall outlet is without electricity due to the tripping of an external AC circuit breaker.  UPS input circuit breaker is tripped.	Ensure the UPS is plugged into a properly wired and grounded outlet. Avoid using extension cords, adapters, or other electrical connectors.  Reset the circuit breaker in the external panel. If the AC circuit breaker trips after UPS starts up, call 1-800-222-5877 for service/warranty replacement.  Reset the circuit breaker by pressing the plunger back in. If the AC circuit breaker trips after UPS starts up, reduce the load on the UPS.
3	<i>Power/Mute</i> button is illuminated red.	UPS has detected an internal fault.	Call 1-800-222-5877 for service/warranty replacement.
4	UPS does not provide expected runtime.	The batteries may be fully discharged or at the end of useful service life.	Charge the batteries for at least 3 hours and retest. If the runtime is still less than expected, check that the UPS is not overloaded.
5	Equipment shuts off when operating in battery mode.	Equipment is plugged into the SURGE ONLY outlet.  UPS has shutdown.	Move this piece of equipment to one of the BATTERY + SURGE outlets.  The battery has discharged. Wait for input AC power to return for the UPS to restart and provide output power.

To contact Vertiv Technical Support: visit [www.Vertiv.com](http://www.Vertiv.com), email at [liebert.upstech@vertiv.com](mailto:liebert.upstech@vertiv.com) or call 1-800-222-5877

© 2023 Vertiv Group Corp. All rights reserved. Vertiv™ and the Vertiv logo are trademarks or registered trademarks of Vertiv Group Corp. All other names and logos referred to are trade names, trademarks or registered trademarks of their respective owners. While every precaution has been taken to ensure accuracy and completeness here, Vertiv Group Corp. assumes no responsibility, and disclaims all liability, for damages resulting from use of this information or for any errors or omissions.

